

LAB

ATELIER KEMPE THILL
ARCHITECTS AND PLANNERS

i.s.m.
schiemann weyers
architects

type B1s

2e verdieping
GO: 61.2m²
bouwnummers: 118, 120
28.03.2025

0 0.5 2m

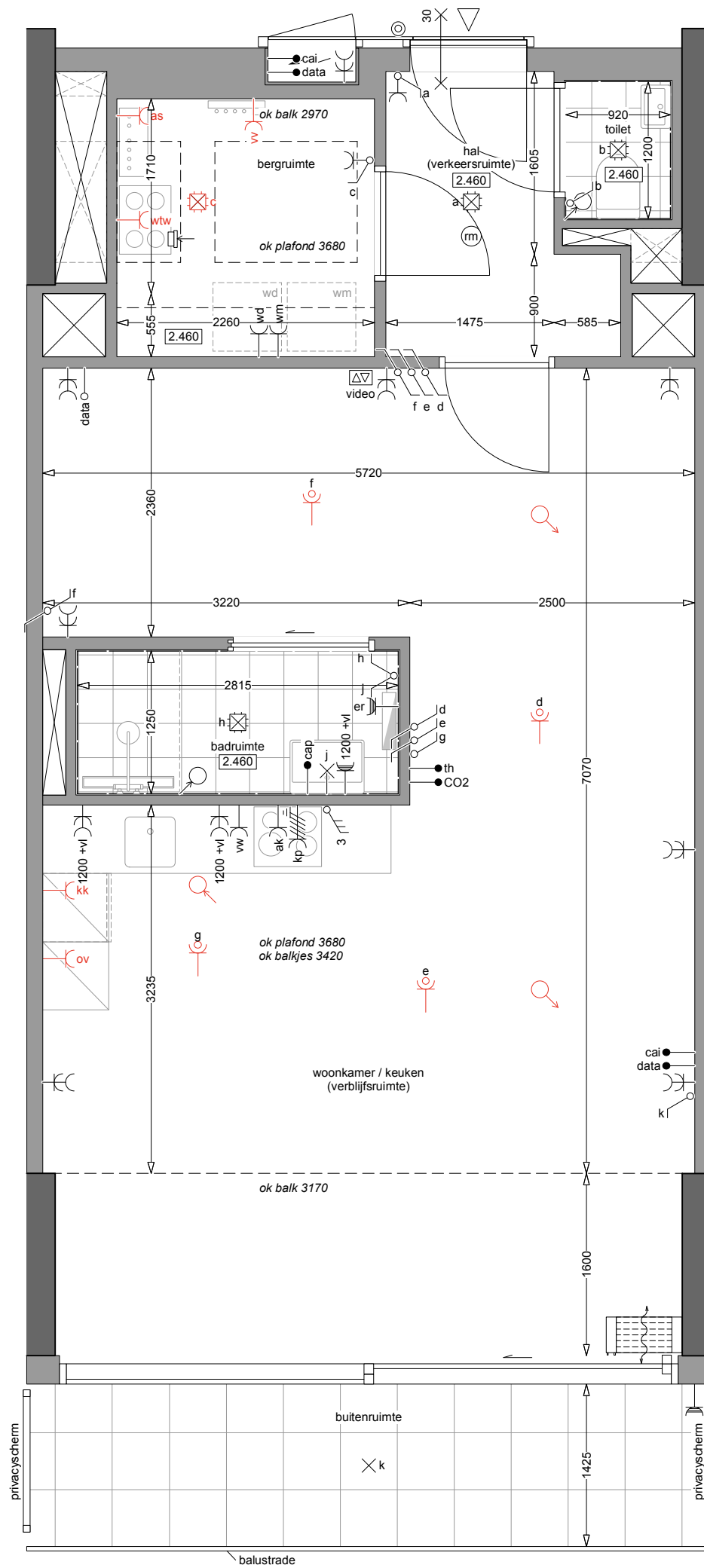

LAB

ATELIER KEMPE THILL
ARCHITECTS AND PLANNERS

i.s.m.
schiemann weyers
architects

type B1s

3e verdieping
GO: 60.6m²
bouwnummers: 106, 108
28.03.2025



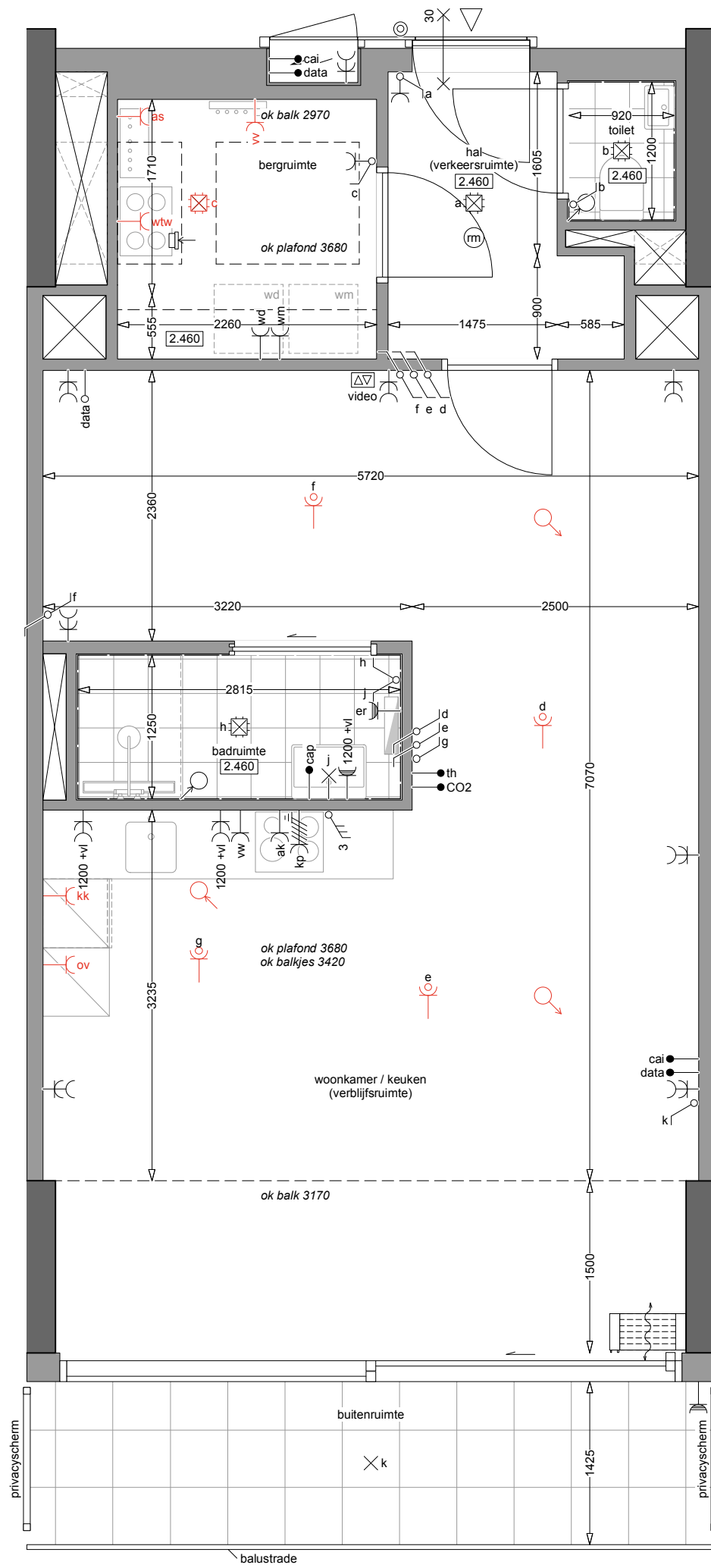

LAB

ATELIER KEMPE THILL
ARCHITECTS AND PLANNERS

i.s.m.
schiemann weyers
architects

type B1s

4e verdieping

GO: 60.1m²

bouwnummers: 90, 92

28.03.2025

0 0.5 2m

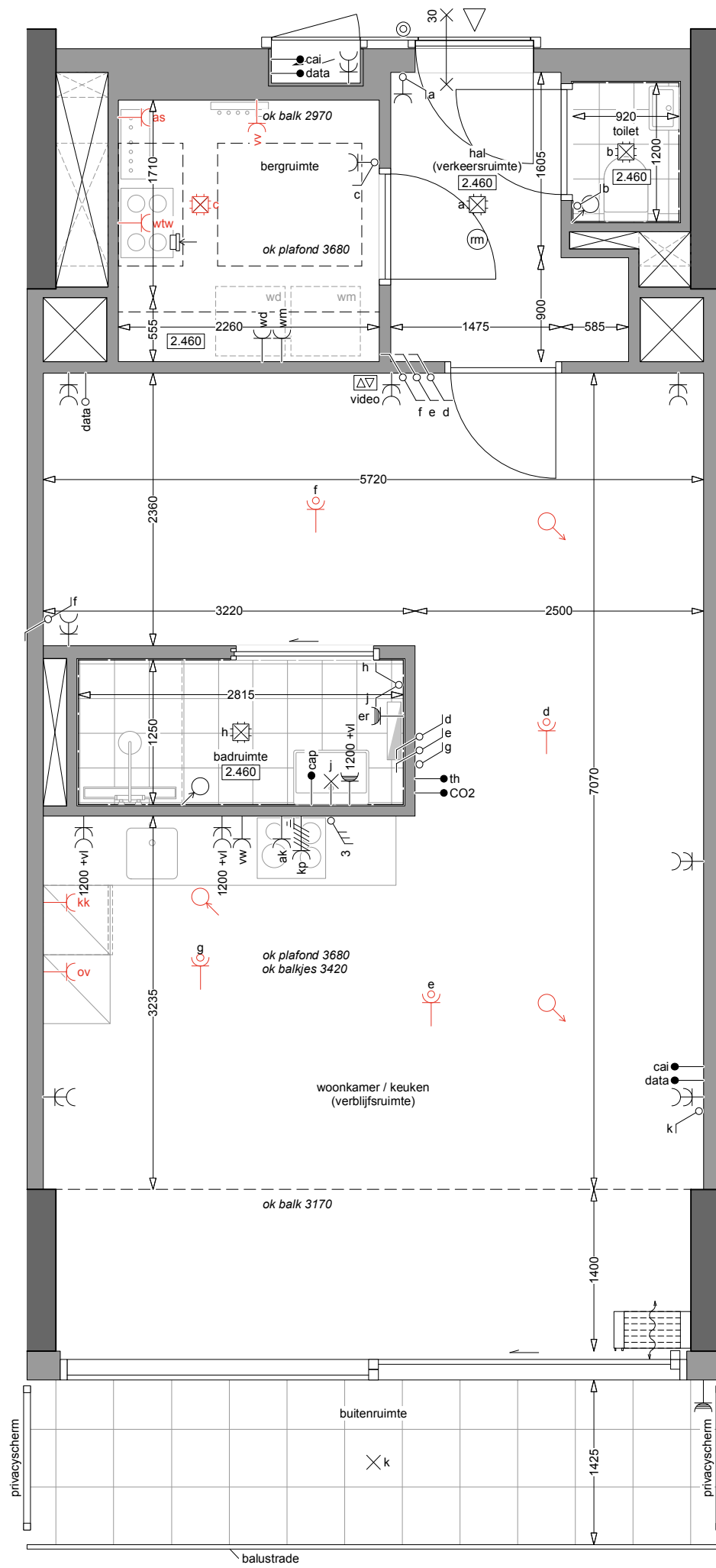

LAB

ATELIER KEMPE THILL
ARCHITECTS AND PLANNERS

i.s.m.
schiemann weyers
architects

type B1s

5e verdieping

GO: 59.5m²

bouwnummers: 72, 74, 76

28.03.2025

0 0.5 2m

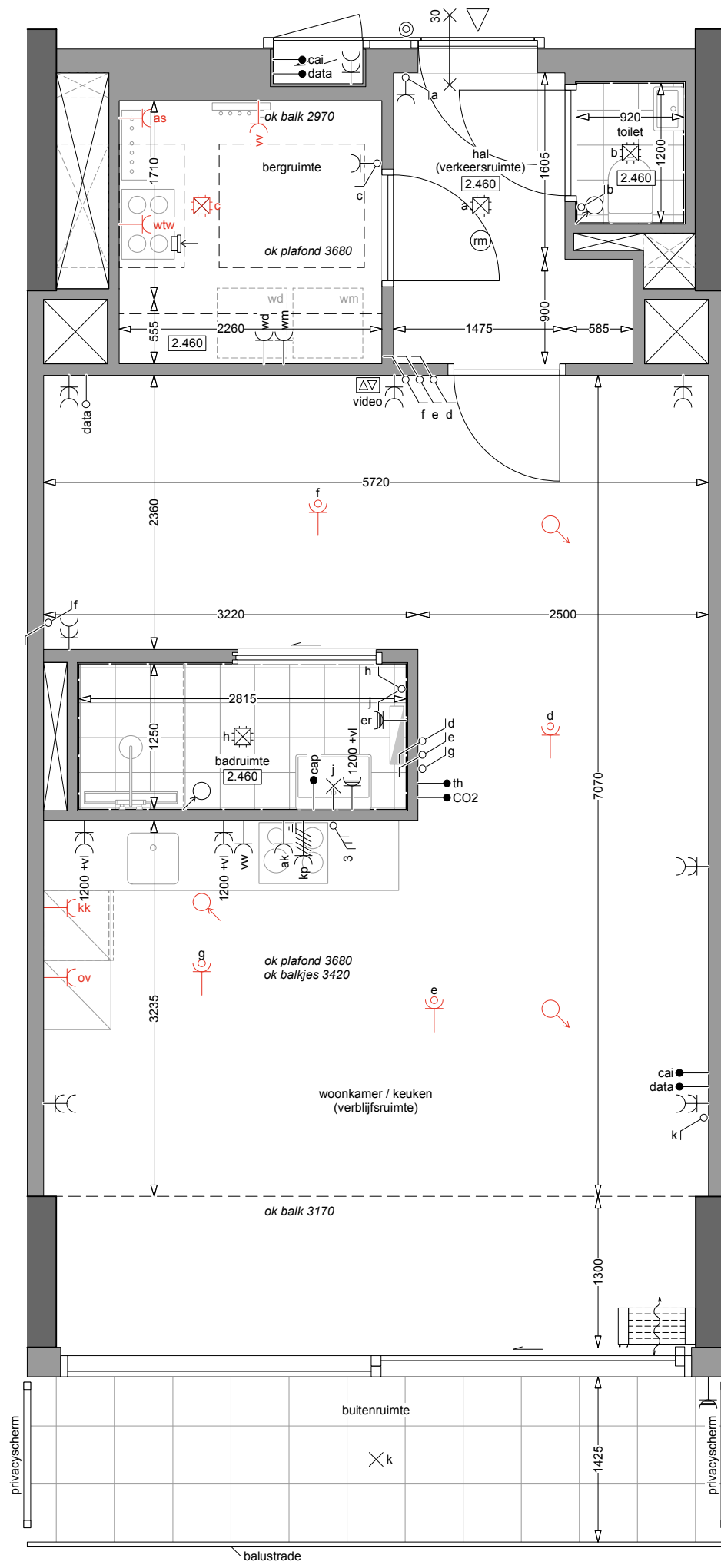

LAB

ATELIER KEMPE THILL
ARCHITECTS AND PLANNERS

i.s.m.
schiemann weyers
architects

type B1s

6e verdieping

GO: 59.0m²

bouwnummers: 56, 58, 60

28.03.2025



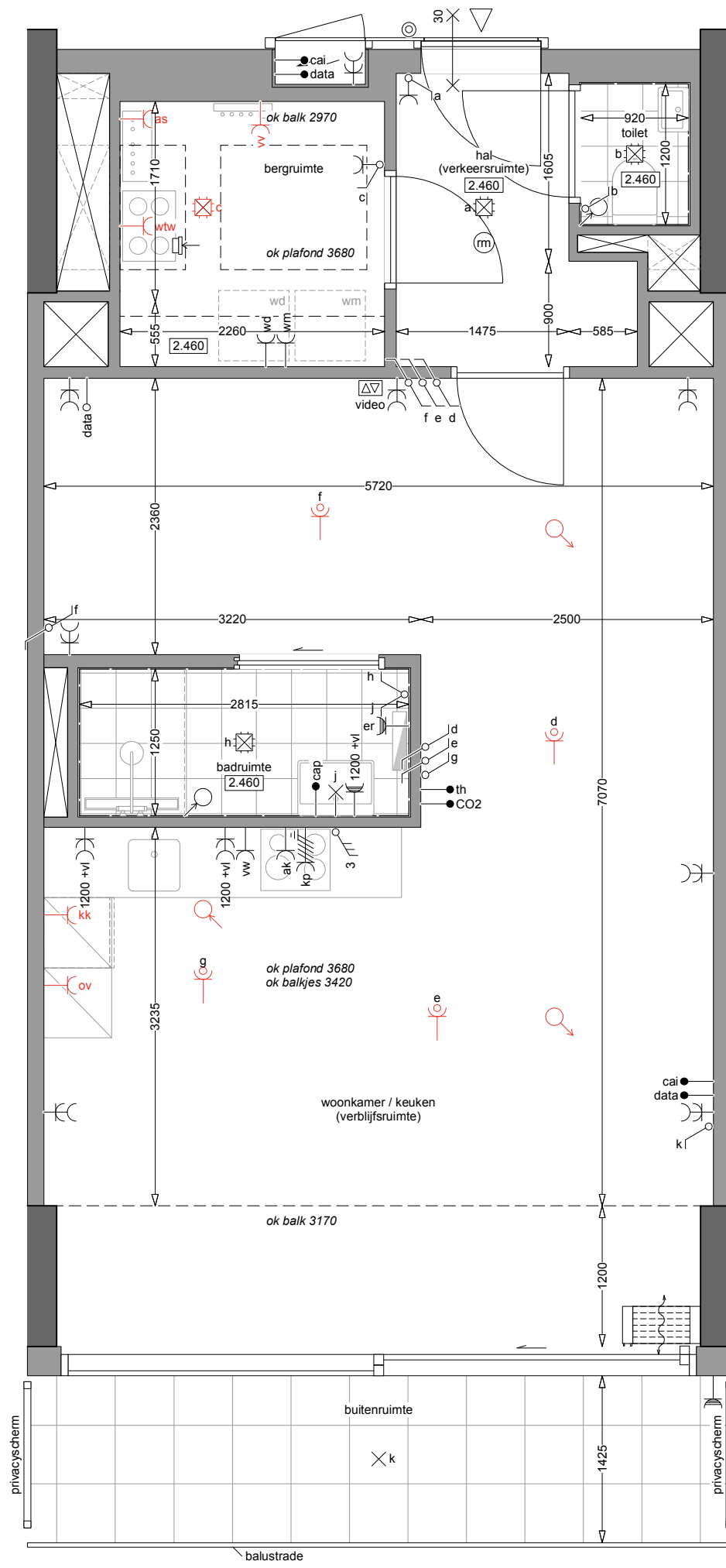

LAB

ATELIER KEMPE THILL
ARCHITECTS AND PLANNERS

i.s.m.
schiemann weyers
architects

type B1s

7e verdieping

GO: 58.4m²

bouwnummers: 40, 42, 44

28.03.2025

0 0.5 2m

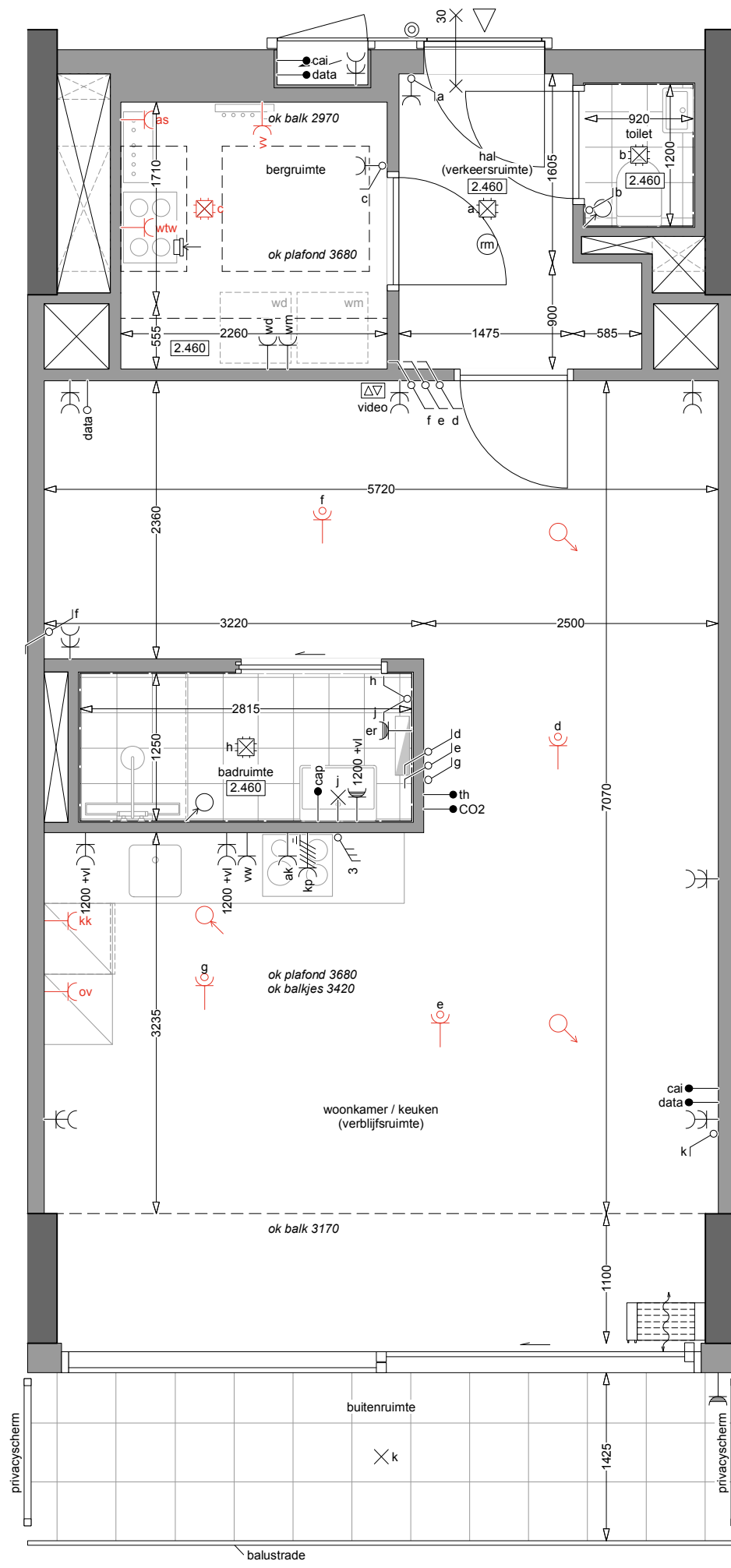

LAB

ATELIER KEMPE THILL
ARCHITECTS AND PLANNERS

i.s.m.
schiemann weyers
architects

type B1s

8e verdieping

GO: 57.9m²

bouwnummers: 24, 26, 28

28.03.2025

0 0.5 2m